

Seat:

Place the seat on the frame. Press the seat firmly. Check by lifting the chair from the seat that it is securely attached to the frame. The front edge of the shower chair is presented in the foreground of the picture on the right.

NOTE!

- * Avoid sitting on the very edge of the seat so that the seat does not come off the frame!

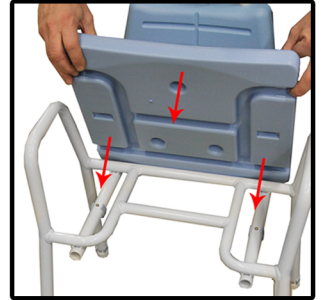

Height adjustment:

Remove the quick locks from the legs of the frame. Push the height adjustment leg inside the frame. Choose the suitable height and lock the leg to the frame by pushing the quick lock back into place.

- * Make sure that the quick locks are properly attached and that they completely penetrate both tubes.

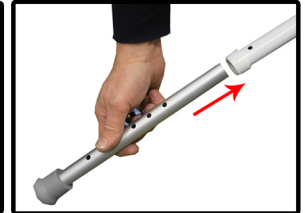
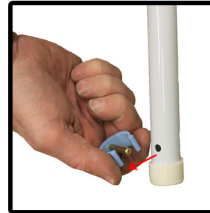

Tilt adjustment:

One of the legs is the tilt adjustment leg, which does not have a rubber plug at all. By turning the padded screw on the end of the leg, the possible tilt of the shower room floor can be equalized.

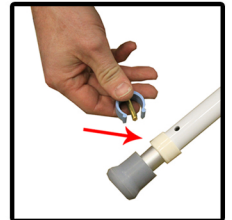

Back rest (accessory):

Remove the quick locks from the backrest. Insert the tubes of the back rest into the frame from the backside (straight intermediate tube). There are two different depths to choose from. Choose the one that suits you best and lock the backrest to the frame with the quick locks.

- * Make sure that the quick locks are properly attached and that they completely penetrate both tubes.

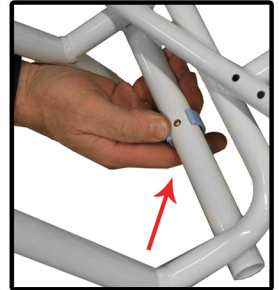

More comprehensive user manuals can be found here:
www.tukimet.fi/ohjekirjat

Watch the commissioning video on YouTube:



Check regularly the general condition of the product and the tightness of the locks. Keep the product clean of all dirt by wiping it with a damp cloth and a mild detergent to keep it in good shape. Have a faulty product serviced at your own assistive device services facility!